

MANDURAH
House Boats



Bookings & enquiries
T: (08) 9535 9898
houseboatsmandurah.com.au
Email: info@houseboatsmandurah.com.au



MH

Rio Sleeps 8

AIRCON

Brand-new in 2023, Rio is a luxurious eight berth houseboat with all the mod-cons. She features two double beds in separate rooms, two bunks and twin single berths in the living area. All linen is provided and the boat boasts reverse-cycle air conditioning, a microwave, Nespresso coffee machine and a Smart TV.

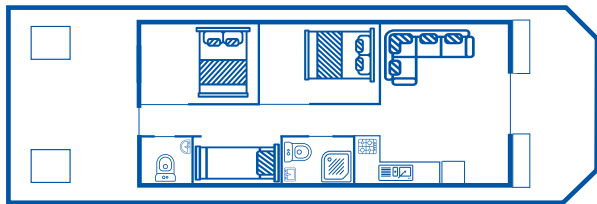
NEW
BOAT

MH

Emily Louise Sleeps 8

AIRCON + SPA

Built in 2020, Emily is WA's only wheelchair-friendly houseboat. A large, luxury boat with reverse-cycle aircon, microwave, Nespresso coffee machine, Smart TV and a spa on the rear deck, all linen is included. Emily has two double bedrooms with queen sized beds, two bunks and a double sofa bed in the living area plus a shower and two toilets.

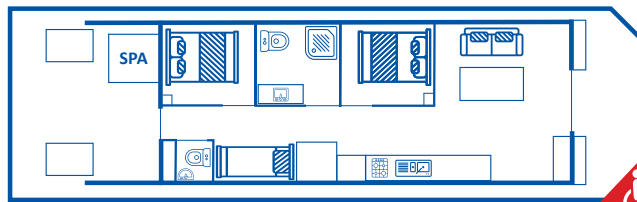

MH

Quicksilver Sleeps 8

AIRCON + SPA

Quicksilver is a large, modern houseboat with a spa, reverse-cycle air-conditioning and tinted glass all-round. The boat has two double bedrooms, a bedroom with four bunks, two toilets and a shower and comes with all linen provided. The galley includes a Nespresso coffee machine and a microwave oven, and there's a Smart TV on board.

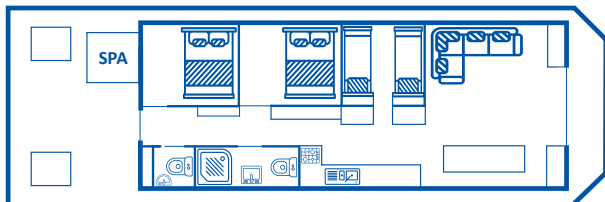

MH

Clancy Sleeps 6

A spacious houseboat that's ideal for two couples, Clancy has two double bedrooms and a large L-shaped lounge that converts to two single berths in the living area. The rear bedroom has an ensuite toilet and the front bedroom has a toilet and shower. There's plenty of space on both decks and she has a Smart TV.

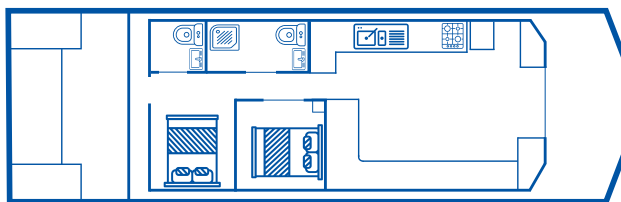

MH

Hakuna Matata Sleeps 8

A spacious houseboat catering for up to three couples, Hakuna features three double bedrooms and two bunks in a rear alcove, as well as a shower and two toilets. She has plenty of storage room, spacious front and rear decks with lots of shade, and the boat is equipped with a Smart TV on board.

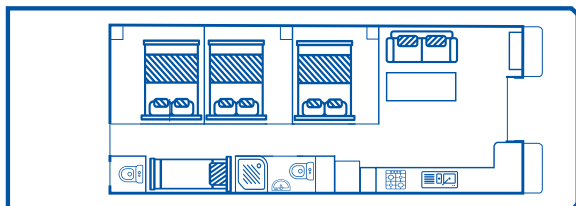

MH

Murray River Queen Sleeps 9

Suitable for a large family or a group of friends, Murray River Queen has two double bedrooms (one of which features a bed with single bunk above), two bunks in a rear alcove, and a sofa that converts to a double bed. Equipped with a shower and two toilets, the boat also has a Smart TV on board.

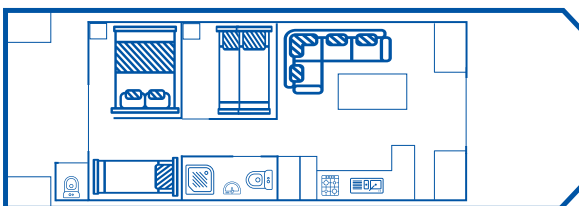

MH

Sarah Jane Sleeps 8

Sarah Jane has a queen bed at the rear of the boat, a bunk room with four bunks, a double sofa bed in the living room area plus a spacious kitchen and a good sized living area. Her large front deck features child-friendly safety netting and the living area has panoramic floor-to-ceiling windows. Sarah Jane has a shower and two toilets.

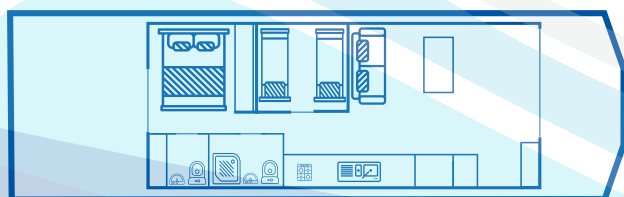

MH

Siesta Sleeps 10

A large and comfortable houseboat, Siesta easily caters for 2 couples and up to six children. Featuring two double bedrooms, a third bedroom with four comfortable bunks and two bunks in the rear passage; she has a spacious living area with open kitchen, dining, shower and two toilets. Siesta has a Smart TV on board.

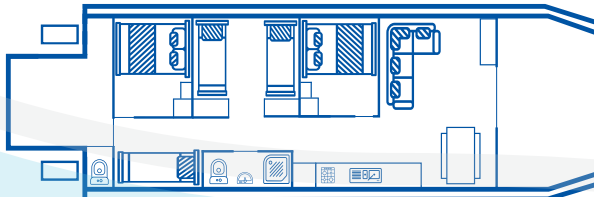

MH

Chloe Sleeps 6

Perfect for two couples, Chloe has two double beds in separate rooms, a small double sofa bed in the lounge, a shower and two toilets. The living/kitchen/dining space is a roomy, open plan area and the boat has large front and rear decks with a swimming platform at the rear. Chloe has a Smart TV on board.

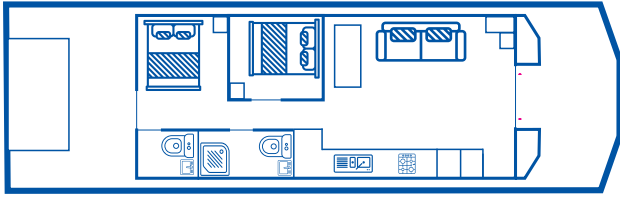

RW

Pelican Sleeps 8

A modern, light, bright and spacious houseboat, Pelican is ideal for a larger family or group of friends. She has two double bedrooms, two bunks in the rear passage and two single berths in the living area. Pelican has a shower and toilet on board and features a large front deck and a shaded rear swim deck.

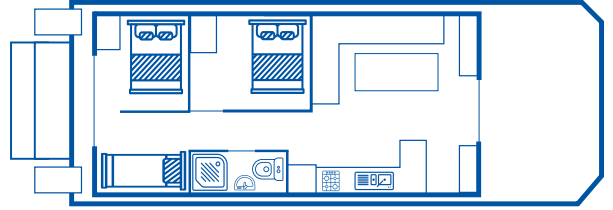

RW

Miss Bianca Sleeps 4

Miss B is the smallest boat on our fleet and she's ideal for a couple, or parents with two children. Completely open plan, she sleeps four in comfort with a double bed and two bunks. As well as a shower and toilet, this boat has everything you need for a comfortable stay, including a rear swim platform and a Smart TV.

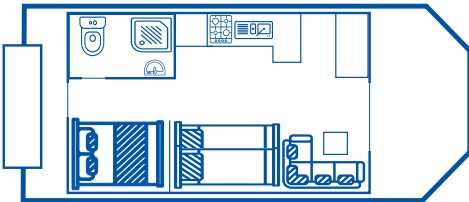

RW

Abby J Sleeps 10

A lovely spacious boat with open plan living areas, Abby J boasts two double beds, a bunk room with two bunk beds, a shower and two toilets. The living area also has two sofas that convert into double beds. She has a good sized foredeck and a swimming platform on the aft deck. The boat has a Smart TV on board.

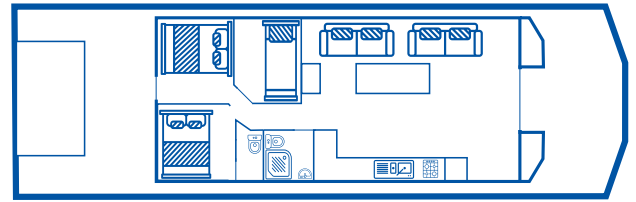

RW

Natalie Anne Sleeps 8

Natalie Anne is a large, comfortable family houseboat with rear double bedroom, a second bedroom offering four spacious bunks, double sofa bed in the living area, and a shower and toilet. The boat has a large, covered front deck, plus a rear deck with shade awning, swim platform and swim ladder and there's a Smart TV on board.

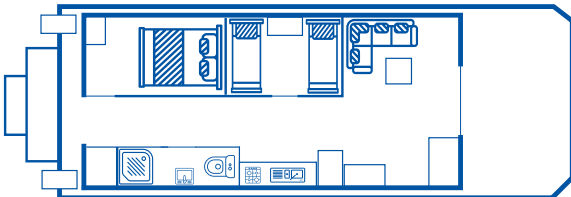

RW

Sophie Sleeps 8-10

Sophie is a large boat with open plan living areas and two double beds in separate rooms. There's another bedroom with two bunk beds and the two sofa beds in the living area convert to double beds. Perfect for a large family or a group of friends, she has good-sized front and rear decks, a shower, two toilets and has a Smart TV on board.

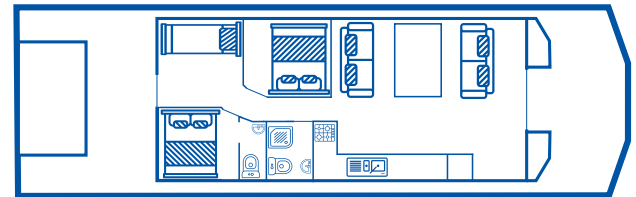

RW

Lifestyle Sleeps 8

Lifestyle is a perennial favourite for two couples with two children each. She has two comfortable double bedrooms, two bunks, a sofa bed that converts to a double bed, and a shower and toilet. The boat has a large covered front deck area as well as a swim platform and ladder at the rear. Lifestyle has a Smart TV on board.

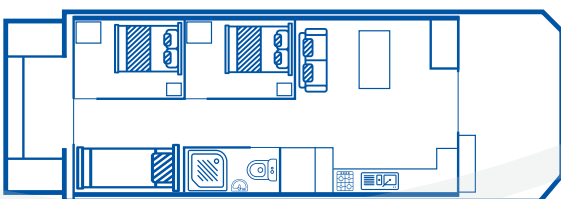

RW

Just Chillin' Sleeps 10

With a large open plan living area, and huge rear deck this boat's perfect for large groups. There's a swimming platform and ladder aft, as well as an outdoor shower. Inside there's a queen bed, bunk room with four bunks and two sofas in the living area fold down to make two more queen-sized beds. The boat has a Smart TV.

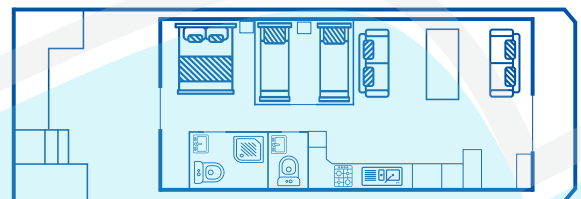

MH

Start at Mandurah
Ocean Marina

RW

Start at
Ravenswood



Wheelchair
friendly

PRICE PER DAY - MINIMUM HIRE 3 DAYS/2 NIGHTS

\$2000 bond for all boats - All prices are GST inclusive

Morning check-in on first day. 3pm check-out on return day.	December 1 to February 28 and Easter school holidays	March 1 to May 31	June 1 TO August 31	September 1 to November 30	CHRISTMAS 24 - 28 December NEW YEAR 30 Dec. - 3 Jan. (5 day minimum)
Miss Bianca (sleeps 4)	\$575 (\$1,725/3 days)	\$495 (\$1,485/3 days)	\$375 (\$1,125/3 days)	\$495 (\$1,485/3 days)	\$610 (\$3,050/5 days)
Lifestyle (sleeps 8) Natalie Anne (sleeps 8) Pelican (sleeps 8) Sarah Jane (sleeps 8)	\$725 (\$2,175/3 days)	\$625 (\$1,875/3 days)	\$470 (\$1,410/3 days)	\$625 (\$1,875/3 days)	\$760 (\$2,280/5 days)
Clancy (sleeps 6) Chloe (sleeps 6) Murray River Queen (sleeps 9)	\$775 (\$2,325/3 days)	\$665 (\$1,995/3 days)	\$495 (\$1,485/3 days)	\$665 (\$1,995/3 days)	\$820 (\$4,100/5 days)
Abby J (sleeps 10) Hakuna Matata (sleeps 8) Just Chillin' (sleeps 10) Siesta (sleeps 10) Sophie (sleeps 8 - 10)	\$890 (\$2,670/3 days)	\$765 (\$2,295/3 days)	\$575 (\$1,725/3 days)	\$765 (\$2,295/3 days)	\$935 (\$4,675/5 days)
Rio (sleeps 8) Aircon & 240v	\$1,065 (\$3,195/3 days)	\$920 (\$2,760/3 days)	\$685 (\$2,055/3 days)	\$920 (\$2,760/3 days)	\$1,120 (\$5,600/5 days)
Emily Louise (sleeps 8) Quicksilver (sleeps 8) Aircon, Spa & 240v	\$1,100 (\$3,300/3 days)	\$955 (\$2,865/3 days)	\$720 (\$2,160/3 days)	\$955 (\$2,865/3 days)	\$1,155 (\$5,775/5 days)

A deposit of \$200 is required to secure a booking. The balance of the hire cost has to be paid 4 weeks prior to departure. For Christmas, New Year & Easter bookings the balance is payable 8 weeks prior to departure. The \$2000 bond is payable via a credit card pre-authorisation at the time of check-in. Fuel is not included in the cost of houseboat hire. Mandurah Houseboats Conditions of Hire apply and prices are subject to change without notice.

All our houseboats are equipped with;

- Kitchenware, cleaning products and tea towels
- Cooktop & oven
- Toilets & showers
- Hot water system
- Fridge/freezer
- 80L Esky
- BBQ
- Smart TV and/or DVD player
- Swim platform with ladder
- Shaded decks
- Outdoor settings
- Crab nets
- GPS & Ctrack Safety Tracking system
- Phone and laptop charging facilities via 240v inverter



DID YOU KNOW?

Mandurah is just a 50 minute drive from Perth.

Houseboats can travel up the Murray River to Redcliffe, a river distance of 23km.

The Peel-Harvey Inlet is 2.5x times the area of Sydney Harbour.

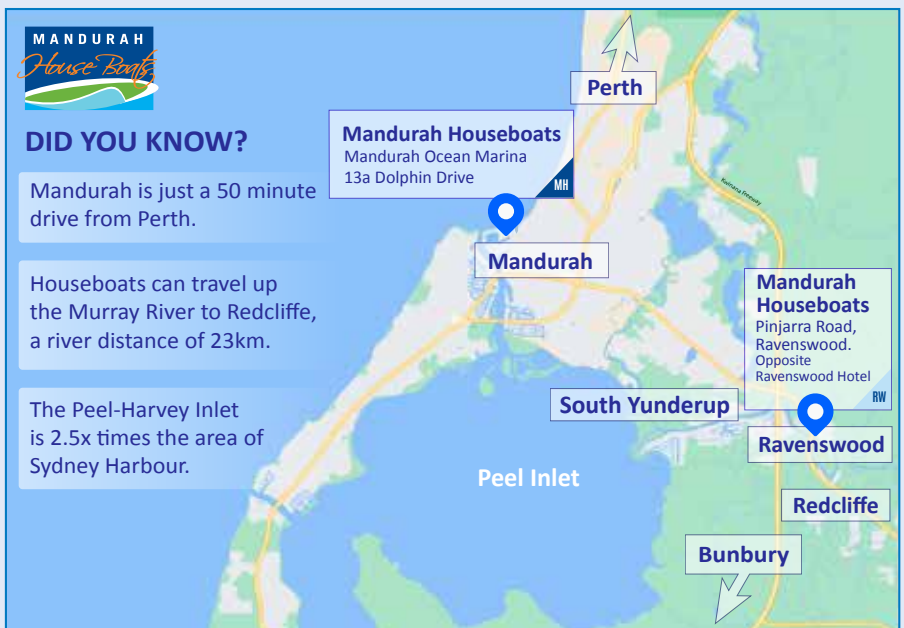

MANDURAH (OFFICE) ■ 13a Dolphin Drive ■ Mandurah Ocean Marina ■ WA 6210
RAVENSWOOD ■ Pinjarra Road ■ Ravenswood ■ (opposite the Ravenswood Hotel)
 houseboatsmandurah.com.au ■ T: (08) 9535 9898